

Type GF - Grate-Fast®

Top Hat: Mild Steel, hot dip galvanized
Stainless Steel Grade 304

Body: Malleable iron, hot dip galvanized / sheraplex

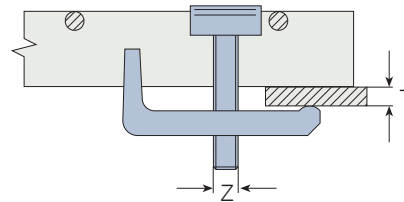
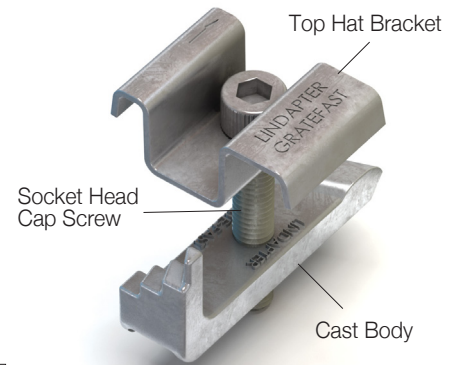
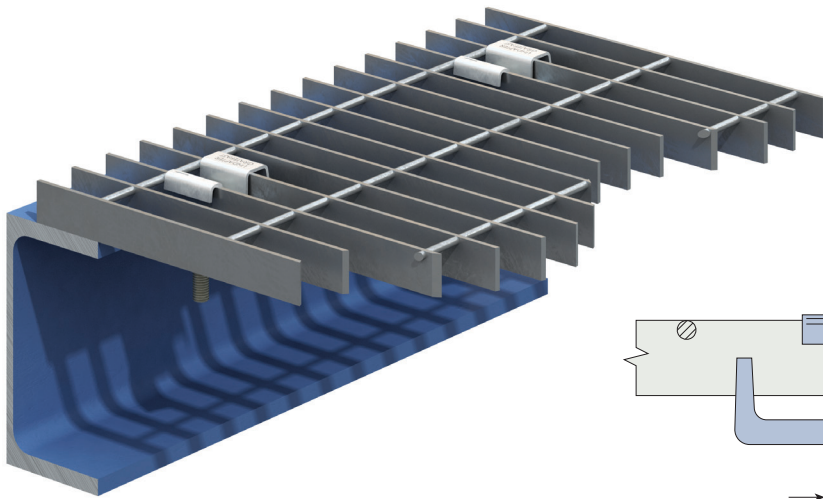

A grating connection for rectangular open bar gratings, with superior clamping force from the cast body. Lloyd's Register Type Approval for vibration resistance.

LGF031 for GRP grating with stainless steel top-hat bracket, sheraplex coated body and screw.
LGF037 (OSB) features an oversized bracket to fit various grating profiles. Galvanized for corrosion resistance.
LGF037 for use with 1³/₁₆" width floor grating bars only. Galvanized for corrosion resistance.

LGF031 / LGF037 (OSB)

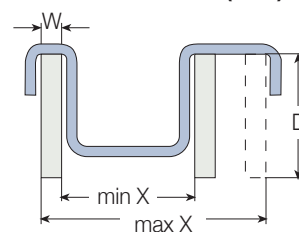

LGF037

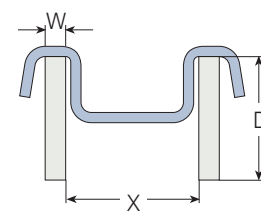

Product Code	Bolt Z	Flange T	Grating Bar Depth D	Grating Bar Width W	Bar Distance X	Body Width	Tightening Torque	Hexagon Key	
								ft lb	mm inches
LGF031	M8	1/8" - 3/4"	7/8" - 1 1/2"	3/16" - 3/8"	3/4" - 1 7/8"	5/8"	4	6	1/4"
LGF037 (OSB) ¹⁾	M10	1/8" - 3/4"	1 3/16" - 1 3/16"	1/8" - 1/4"	1" - 1 3/4"	3/4"	8	8	5/16"
LGF037 ¹⁾	M10	1/8" - 3/4"	3/4" - 1 1/4"	1/8" - 1/4"	1 3/16"	3/4"	8	8	5/16"

1) May be supplied with a hex head screw.

■ Order example: LGF031

Installation

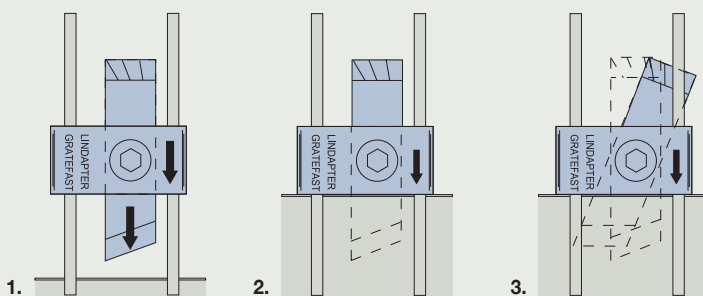

1. Position pre-assembled Grate-Fast with body between grating bars and nose pointing toward the steel. The arrows on the top hat bracket should also be pointing toward supporting steel and bracket itself resting on the bearing bars.
2. Slide Grate-Fast toward steel until nose fits under the beam flange. Where necessary, adjust body/screw to approximate flange thickness/grating depth.
3. Tighten cap screw. The Grate-Fast body will automatically rotate until it locks under the bearing bar, with the nose under the flange. Continue tightening to the recommended torque.